

WIRELESS 2 & 3 WAY SWITCH KITS



Pre-Configured Controller and Switch(es) for Wireless Lighting Control

Simply wire the controller to your lighting load, then place the pre-linked switches

- Works out of the box - No programming - No cross talk between kits
- Switches rated to 50,000 operations - No batteries, switches are self-powered
- Transmission range of 100 m (330 ft.) line of sight; 24 m (80 ft.) for interior spaces
- Ideal for renovations - No alteration of wallboard or hard ceilings as with wired switch legs
- Added convenience of having switches where they are most accessible - No mounting hardware required
- Use anywhere that you do not want to disturb construction material with wired switch legs, ie. Heritage Buildings, Log homes or spaces with pre-existing hazardous materials.
- Use anywhere long switch legs are required: detached garages, sheds, barns, boathouses, pathways or ground lighting

2-WAY SWITCHING

EKIT INSTALLATION

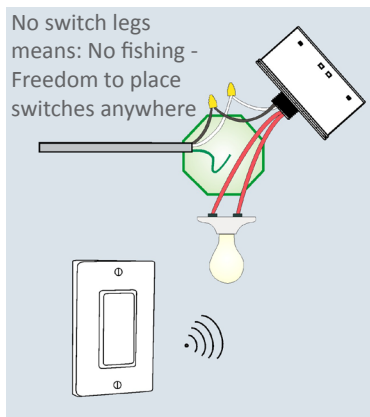

TRADITIONAL INSTALLATION

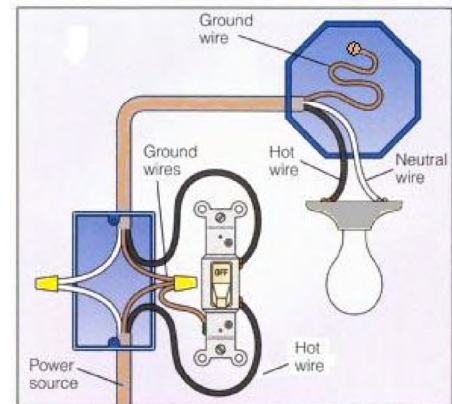

Ordering Information

Model	Description	Part # *=120V	Part # *=120/277V	Part # *=120/347V
EKIT-R-1PC-W (*)	Single switch and controller kit - white	001-0707	001-0721	001-0745
EKIT-R-2PC-W (*)	Two switch and controller kit (3 way) - white	001-0719	001-0733	001-0757

simply smart

automated energy conservation for home, office and planet



EKIT

3-WAY SWITCHING

EKIT INSTALLATION

Self-powered - No batteries - No wired switch legs

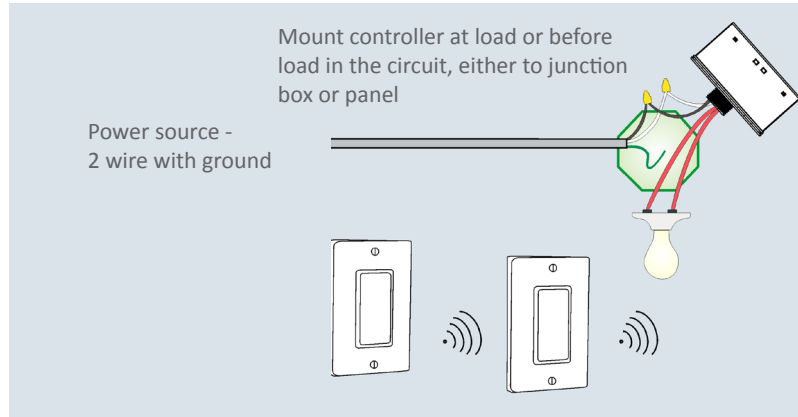

TRADITIONAL WIRED INSTALLATION

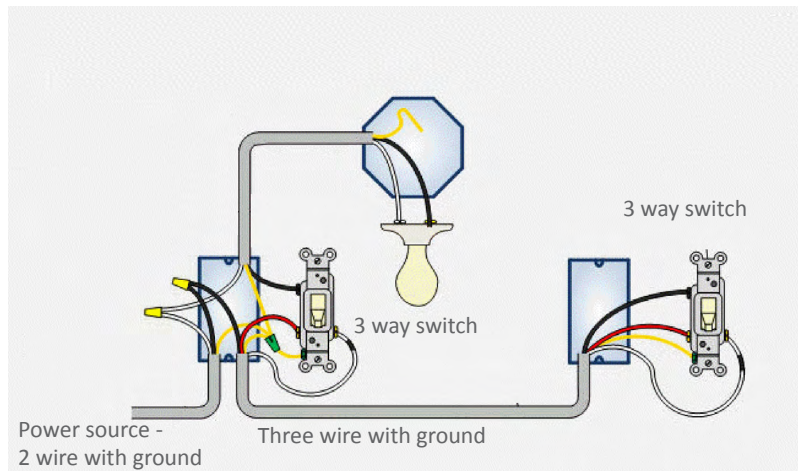

Agency Listing & Compliance

Safety

ETL Recognized Component
Conforms to UL Standard 508
Certified to CAN/CSA Std. C22.2 No.14
UL 2043 Plenum rated



Radio Frequency

FCC Part 15.231 -Remote Control Transmitter
IC RSS-210



Echoflex Solutions, Inc.

#1, 38924 Queens Way | Squamish | BC | Canada | V8B 0K8
Toll Free: 888-324-6359 | Phone: (778) 733-0111 | Fax: (604) 815-0078
email: info@echoflexsolutions.com | www.echoflexsolutions.com

Specifications are subject to change without notification.

